

Twin Rod Cylinder

Double Acting, Single Rod

Series TN



◆ How to Order

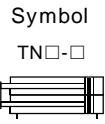
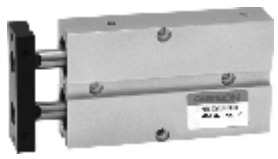

TN 20-50

Cylinder stroke
* Refer to "Standard stroke".

Bore size

10	16	20	25	32
----	----	----	----	----

Model

TN	Twin rod cylinder, built-in magnet, double acting; single rod
----	---------------------------------------------------------------

◆ Specifications

Bore size (mm)	10	16	20	25	32
Action	Double acting, single rod				
Fluid	Filtered compressed air				
Proof pressure	1.5 MPa				
Operating pressure range	0.1~0.9 Mpa				
Ambient and fluid temperature	-5~70°C (No freezing)				
Port size	M5×0.8				Rc1/8
Cushion	Rubber bumper				
Stroke adjustable range	0 to -10mm compared to the standard stroke.				

◆ Standard Stroke

Bore size (mm)	Standard stroke(mm)													Maximum stroke	Available stroke
10	10	20	30	40	50	60	70							70	100
16	10	20	30	40	50	60	70	80	90	100	125	150		150	200
20	10	20	30	40	50	60	70	80	90	100	125	150		150	200
25	10	20	30	40	50	60	70	80	90	100	125	150		150	200
32	10	20	30	40	50	60	70	80	90	100	125	150		150	200

◆ Dimensions

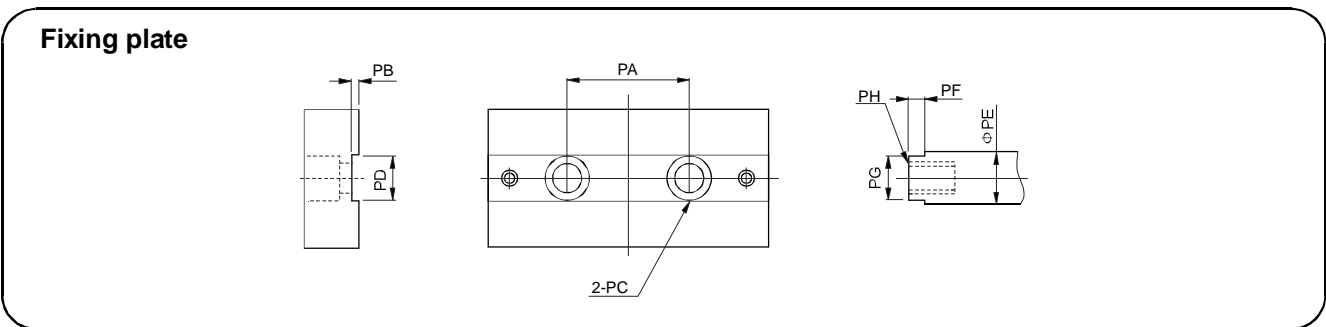

Bore size(mm)	PA	PB	PC	PD	PE	PF	PG	PH
10	18	0.7	Φ 6.2×3.5dp Thru. hole: Φ 3.3	5.2	6	2.2	5.1	M3×3.5 5.5dp
16	24	1	Φ 7.8×4.6dp Thru. hole: Φ 4.3	6.2	8	3	6.1	M4×0.7 9dp
20	28	1	Φ 11×6.8dp Thru. hole: Φ 6.5	8.2	10	3	8.1	M6×1 10dp
25	34	1	Φ 11×6.8dp Thru. hole: Φ 6.5	10.2	12	3	10.1	M6×1 10dp
32	42	2	Φ 17×12dp Thru. hole: Φ 10.5	14.2	16	3	14.1	M10×1.5 13dp

I

CJP

CJ1

DNC

DNCB

DNG

C95

SI

CS1

MB

SU

SC

DSNU

C85

CJ2

CM2

MA

MAL

ADVU

CQ2

CQS

SDA

CU

DPZ

CXS

TN

ADVUL

CQM

MGP

MGG

CRA 1

CY1B

CS

Auto switch

D

Auto switch

AC,AD

HR

RB

RBQ

Twin Rod Cylinder

Double Acting, Single Rod

Series TN

TN □-□ Φ 10

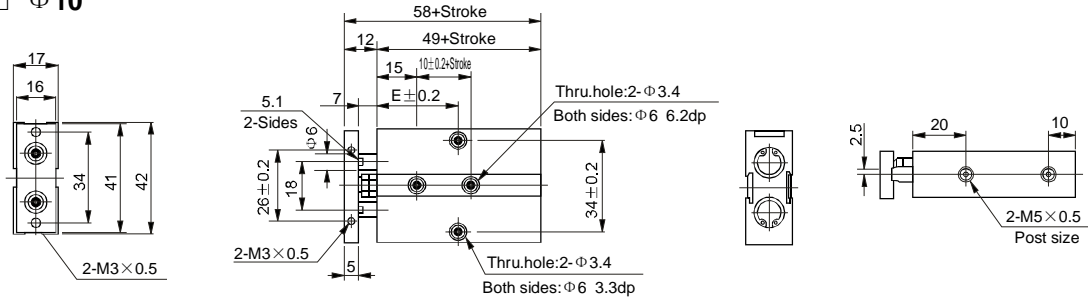

TN □-□ Φ 16, 20, 25

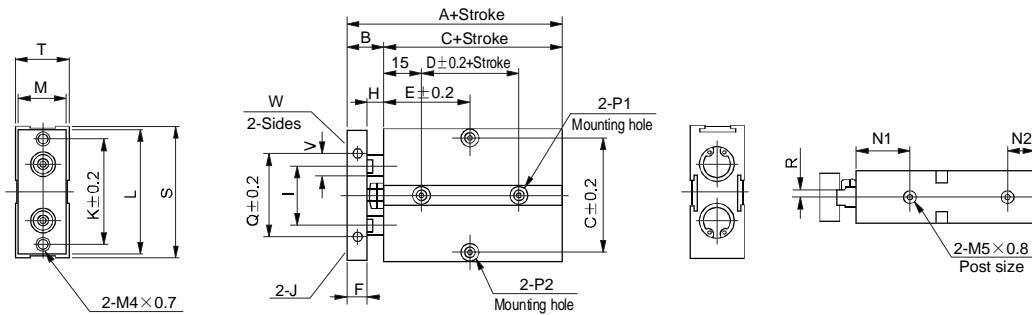

Stroke	10	20	30	40	50	60	70
E	30	30	35	40	45	50	55

Bore size(mm)	A	B	C	D	Stroke ≤	10	20	30	40	50	60	70	80	90	100	125	150	F	G	H	I
16	68	15	53	20	E	30	35	40	45	50	55	60	65	70	75	87.5	100	8	47	7	24
20	78	20	58	20	E	35	35	40	45	50	55	60	65	70	75	87.5	100	10	55	10	28
25	81	19	62	30	E	40	40	45	50	55	60	65	70	75	80	92.5	105	10	66	9	34

Bore size(mm)	J	K	L	M	N1	N2	P1	P2	Q	R	S	T	V	W
16	M4×0.7dp5	47	53	20	22	11	Both sides: Φ 7.5dp7.2mm Thru.hole: Φ 4.5	Both sides: Φ 8dp4.5mm Thru.hole: Φ 4.5	34	3	54	21	8	6.1
20	M4×0.7dp5	55	61	24	25	12	Both sides: Φ 7.5dp7.2mm Thru.hole: Φ 4.5	Both sides: Φ 8dp4.5mm Thru.hole: Φ 4.5	44	3.5	62	25	10	8.1
25	M4×0.7dp6	66	72	29	27	12	Both sides: Φ 7.5dp7.2mm Thru.hole: Φ 4.5	Both sides: Φ 8dp4.5mm Thru.hole: Φ 4.5	56	6	73	30	12	10.1

TN □-□ Φ 32

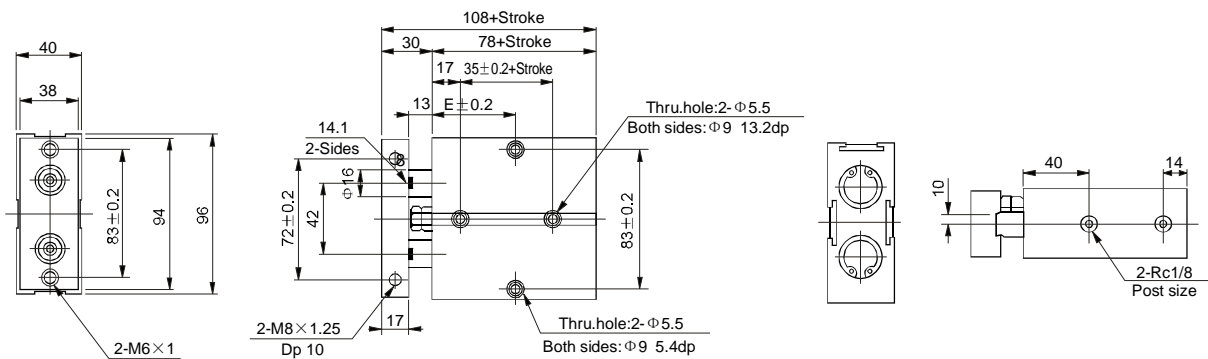

Stroke ≤	10	20	30	40	50	60	70	80	90	100	125	150
E	45	50	55	60	65	70	75	80	85	90	102.5	115