

# Hose Barb Fittings

Brass Plated With Nickel

## Series PB

**ANSSION**  
PNEUMATIC & HYDRAULIC

### APPLICABLE TUBING

Tube I.D.	Φ4	Φ6	Φ8	Φ10	Φ12	Φ14	Φ16
Code	04	06	06	10	12	14	16

### CONNECTION THREAD

Thread size	M5×0.8	R(Rc)1/8	R(Rc)1/4	R(Rc)3/8	R(Rc)1/2	R(Rc)3/4
Code	M5	01	02	03	04	06

### Male Connector: PBC



**PBC** **I.D.** - **R**

PBC4-M5	PBC8-01	PBC12-02
PBC4-01	PBC8-02	PBC12-03
PBC4-02	PBC8-03	PBC12-04
PBC4-03	PBC8-04	PBC14-02
PBC6-M5	PBC10-01	PBC14-03
PBC6-01	PBC10-02	PBC14-04
PBC6-02	PBC10-03	PBC16-03
PBC6-03	PBC10-04	PBC16-04
PBC6-04	PBC12-01	PBC16-06

### Male Connector: PBD

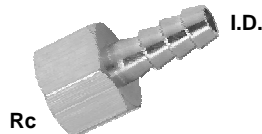

**PBD** **I.D.** - **Rc**

PBD4-M5	PBD8-01	PBD12-02
PBD4-01	PBD8-02	PBD12-03
PBD4-02	PBD8-03	PBD12-04
PBD4-03	PBD8-04	PBD14-02
PBD6-M5	PBD10-01	PBD14-03
PBD6-01	PBD10-02	PBD14-04
PBD6-02	PBD10-03	PBD16-03
PBD6-03	PBD10-04	PBD16-04
PBD6-04	PBD12-01	PBD16-06

### Male Branch Tee (360° rotation): PBE



**PBE** **I.D.** - **R**

PBE4-M5	PBE8-01	PBE12-02
PBE4-01	PBE8-02	PBE12-03
PBE4-02	PBE8-03	PBE12-04
PBE4-03	PBE8-04	PBE14-02
PBE6-M5	PBE10-01	PBE14-03
PBE6-01	PBE10-02	PBE14-04
PBE6-02	PBE10-03	PBE16-03
PBE6-03	PBE10-04	PBE16-04
PBE6-04	PBE12-01	PBE16-06

### Male Run Tee(360° rotation): PBY



**PBY** **I.D.** - **R**

PBY4-M5	PBY8-01	PBY12-02
PBY4-01	PBY8-02	PBY12-03
PBY4-02	PBY8-03	PBY12-04
PBY4-03	PBY8-04	PBY14-02
PBY6-M5	PBY10-01	PBY14-03
PBY6-01	PBY10-02	PBY14-04
PBY6-02	PBY10-03	PBY16-03
PBY6-03	PBY10-04	PBY16-04
PBY6-04	PBY12-01	PBY16-06

### Male Elbow(360° rotation): PBL



**PBL** **I.D.** - **R**

PBL4-M5	PBL8-01	PBL12-02
PBL4-01	PBL8-02	PBL12-03
PBL4-02	PBL8-03	PBL12-04
PBL4-03	PBL8-04	PBL14-02
PBL6-M5	PBL10-01	PBL14-03
PBL6-01	PBL10-02	PBL14-04
PBL6-02	PBL10-03	PBL16-03
PBL6-03	PBL10-04	PBL16-04
PBL6-04	PBL12-01	PBL16-06

### Straight Union: PBI



**PBI** **I.D.** - **I.D.**

PBI4-4	PBI10-10	PBI16-16
PBI6-6	PBI12-12	
PBI8-8	PBI14-14	

### Union Tee: PBT



**PBT** **I.D.** - **I.D.**

PBT4-4	PBT10-10	PBT16-16
PBT6-6	PBT12-12	
PBT8-8	PBT14-14	

- IV
- KJ
- KQ2
- RP
- GP
- PF
- PN
- PK
- PB**
- Y
- MQC
- BSL
- AS
- RQ
- PU
- AG,DG